

# HOT DOG

## User's Manual



[yc.onion](#)   [YC Onion](#)  
[YC.Onion](#)   [yconionfilm](#)  
[www.yconionca.com](#)   [Follow us for more!](#)

## PRODUCT OVERVIEW

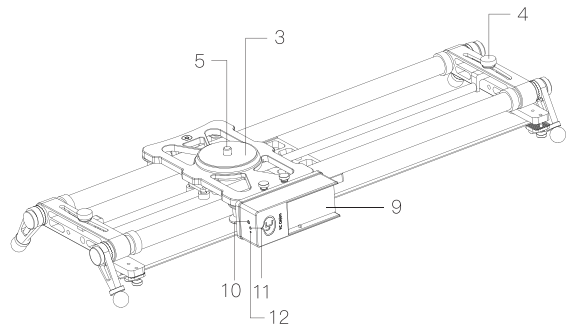
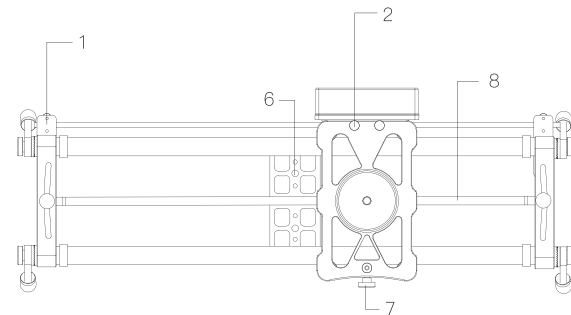

- |                          |                            |
|--------------------------|----------------------------|
| 1 – belt fastener        | 7 – slider lock            |
| 2 – motor mount screw    | 8 – prlx & pan bar         |
| 3 – pan plate            | 9 – battery jar            |
| 4 – bar fastener         | 10 – power jack            |
| 5 – 3/8 screw            | 11 – power light           |
| 6 – 1/4 & 3/8 base mount | 12 – 2.5mm cable interface |

## DOWNLOAD APP

### Apple IOS

Search “CHOCOLATE slider” in [APP Store](#)  
 \* Need IOS7.0 or higher version, compatible with iphone, ipad and ipod touch.

### Android

Search “CHOCOLATE slider” in [Google play](#)  
 \* Need Android 4.3 or higher version, compatible with Android mobile phone.



Scan QR code  
 Download CHOCOLATE Android APP

## POWER SUPPLY MODE FOR SLIDER

### 1.Battery

Hot Dog Motorized Camera Slider can be powered by the battery (F550/F750/F970 battery)

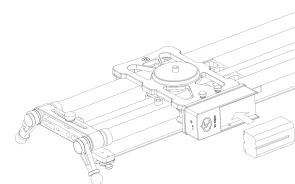

### 2.Mobile Power

With the official mobile power extension cable, a majority of power bank can power the Hot Dog Motorized Camera Slider. A 10000 mAh power bank can last for about 60 hours.

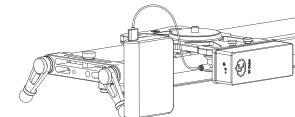

\* As the motorized module doesn't have a on-off button, if it is not used for a long time, please remove the battery or the power bank to stop the power supply.

## HOW TO USE WITH GEARS

### 1.Mount On 1 Tripod

A 3/8 screw is on the top of the sliding block, which can mount a tripod head with 3/8 screw hole.

- \* Except tripod, if the devices exceed 3.3lb/1.5kg, there will be a tilting.
- \* Tripod head with 3/8 screw hole is supported only.
- \* Tripod head and Tripod is not included in the package.



### 2.Mount On 1 Tripod And a Pair Of Stability Arms

A 3/8 & 1/4 base mount can be connected with a tripod directly. 3/8 & 1/4 screw holes are at the both ends, with a pair of stability arms, the stability of slider will be greatly increased.

- \* The safety bearing capacity of the stability arms is within 11lb/5kg.
- \* Tripod, Tripod head and Stability Arms is not included in the package.



### 3.Mount On 2 Tripods

3/8 & 1/4 screw holes are at the both ends, with two tripods, the stability of slider will be greatly increased.

- \* Tripod head/tripod with 3/8 and 1/4 screw hole is supported only.
- \* The safety bearing capacity of two tripods is within 22lb/10kg.
- \* Tripod head and Tripod is not included in the package.



## MODES

Turn on Hot Dog motorized camera slider, initiate Bluetooth function of phone and click on “CHOCOLATE slider” APP. And mobile phone can connect to Hot Dog motorized camera slider.

\* Because of no code match when we connect mobile phone and Hot Dog motorized camera slider, if there are two Hot Dog motorized camera sliders working at the same time, “CHOCOLATE slider” app will match a slider at random.

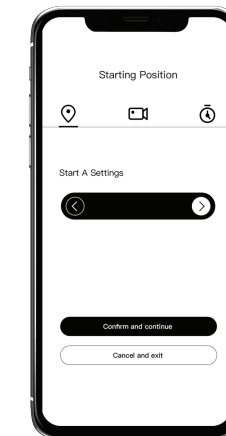

Starting Position Mode

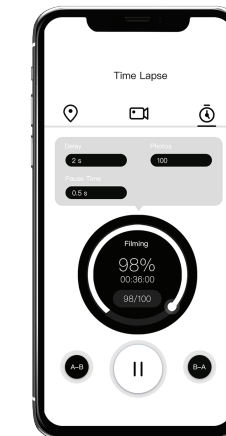

Time Lapse Mode

### 1.Starting Position Mode

This mode is use for setting up the starting point and end point of the slider. **Long press** on the button to move the slider to the position you want (Position A), and click “Confirm and continue”. Then **long press** on the button to move the slider to the position you want (Position B), and click “Confirm and continue”. The setting is finished.

WARRANTY INFORMATION

USER INFORMATION

NAME \_\_\_\_\_ TEL \_\_\_\_\_

EMAIL \_\_\_\_\_ ADD \_\_\_\_\_

PRODUCTS INFORMATION

PRODUCT NAME \_\_\_\_\_

PRODUCT MODEL \_\_\_\_\_

DATE OF PRODUCTION \_\_\_\_\_

WARRANTY PERIOD \_\_\_\_\_

TERMS OF WARRANTY  
1.Warranty period is 1 year , which begins from the purchasing date.  
2.No warranty for disassembly without authorization or damage caused by human.

EHD\_B\_UM\_2.0

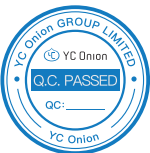

DISCLAIMER

1.The Company assumes no liability for any risks related to or resulting from the debug and use of this product (including the direct, indirect or third-party losses).

2.For any unknown sources of acquitting this product, we will not be at any services.

3.The updating and changes of product firmware and program may cause changes in function descriptions in this user manual, please read the instructions carefully before upgrading the firmware and use the correspond-ing user manual.

4.There may be a description that does not conform to this specification after firmware upgrade of the product. Please be subject to the latest product information which is issued in official website.

5.The Company reserves all rights of interpretation to this product.

SPECIFICATIONS

PRODUCT	YC Onion Hot Dog Plxr & Pan Slider with APP
SIZE (in / cm)	1: 26.1*9.4*2.3 / 66.3*24*6 2: 33.9*9.4*2.3 / 86.3*24*6 3: 41.8*9.4*2.3 / 106.3*24*6 4: 49.7*9.4*2.3 / 126.3*24*6
NET WEIGHT (lb / kg)	1: 4.30 / 1.95 2: 4.52 / 2.05 3: 4.74 / 2.15 4: 4.85 / 2.2
MOTOR HORIZONTAL LOADING CAPACITY	22lb / 10kg
MOTOR≤45° TILT LOADING CAPACITY	6.2lb / 2.8kg
MOTOR≤90° TILT LOADING CAPACITY	4.4lb / 2.0kg
SLIDER LOADING CAPACITY	22lb / 10kg
MOUNTING SCREW HOLE	3/8 for top, 1/4 & 3/8 for bottom
ADDITIONAL FEATURES	Starting position mode,Time lapse mode, Video shot mode
MATERIAL	Aluminium alloy 、 carbon fiber
BATTERY LIFE	Standard F970 battery ≈ 24 hours
COMPATIBILITY	Android 4.3 or higher,iOS7.0 or higher
FUNCTIONS	Mechanized/motorized Parallel, Mechanized/motorized Panorama, Mechanized/motorized Parallax

SHOOTING MODES

1.Parallax Shot

Move the prlx & pan bar left side up, right side down for Parallax Shot. For better parallax, don't forget to adjust center focus right on the subject,and then move sliding block to left/right end,adjust lens focus on the subject while moving the adjusting rod.



2.Panorama Shot

Move prlx & pan bar left side down/right side up for panorama. Feel and define your own Hot Dog panorama shots.



2.Time Lapse Mode

This mode is used for time-lapse shooting, common functions are:  
– Delay: time interval of shooting each photo.  
Unit is second(s), adjustment range: 1s–999s.  
– Photos: how many photos do you want in this time-lapse shooting.  
Adjustment range: 1–∞. If you adjustment is 100,camera will shoot 100.photos before it stop shooting.  
– Moving direction control: adjust moving direction.

\* To film a time lapse, it needs a 2.5mm shutter line that fits the camera ( shutter line is not include in the package, and need to buy separately)  
\* Both video shot mode and time lapse mode have the function of "automatic round". But we can only open or close this function in video shooting mode interface.



Video Shot Mode

3.Video Shot Mode

This mode is used for video shooting, common functions are:  
– Soft-start function: To avoid jerky video which cause by fast start-up,the slider will begin with a soft start.  
– Speed control: Adjust speed fast or slowly.  
– Moving direction control: Adjust moving direction  
– Pause: Pause to work.  
– Auto round: Open this function, sliding block will return automatically when it arrived the end of slider.

\* At the same speed, the larger angle of inclination of slider is, the slower speed slider moves.

4.Offline Function

After setting moving parameters in "CHOCOLATE slider"APP, you can exit "CHOCOLATE slider", even turn off your phone. It doesn't affect Hot Dog motorized camera slider work. However, if you switch video shot mode to time lapse mode, slider will stop working. Also, if you switch time lapse mode to video shot mode, offline function will be not work.