

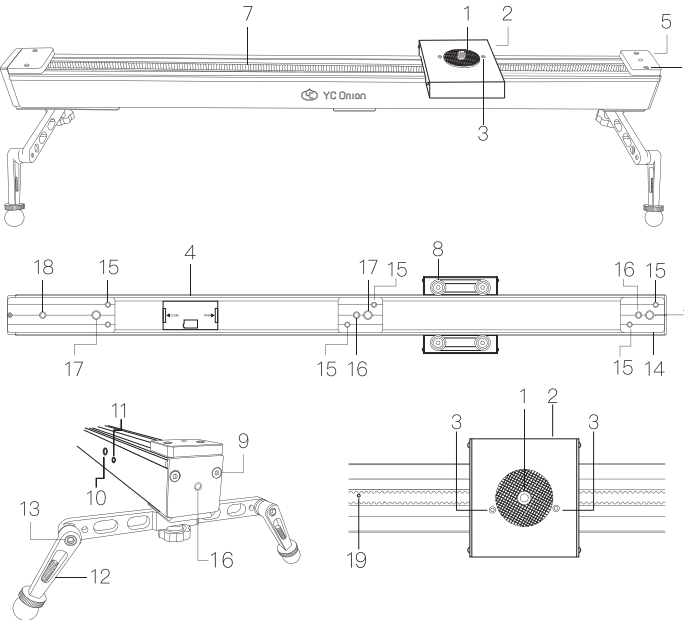

產品概覽



- | | |
|-----------------|---------------------------------------|
| 1 - 頂部螺絲: 3/8螺絲 | 11 - 快門線孔 |
| 2 - 頂部滑塊 | 12 - 支撐腿 |
| 3 - 頂部鬆緊六角螺絲 | 13 - 支撐腿六角螺絲 |
| 4 - 電池盒 | 14 - 下快裝板 |
| 5 - 上護塊 | 15 - 下快裝板六角螺絲 |
| 6 - 上護塊六角螺絲 | 16 - 1/4螺絲孔 |
| 7 - 皮帶 | 17 - 3/8螺絲孔 |
| 8 - 滑輪 | 18 - 電機安全螺絲孔(切勿用過長螺絲裝載此孔, 否則有可能會損壞電機) |
| 9 - 側護蓋六角螺絲 | 19 - 電源燈 |
| 10 - 電源孔 | |

產品清單及功能

標配

收納包、CHIPS電控滑軌主體、支撐腿x2、移動電源轉接線、六角扳手

選配

快門線、滑軌電池(NP-FW50電池)、充電器、蟹鉗支撐桿x2、三腳架、球形雲台、液壓雲台

APP下載

蘋果IOS用戶

APP Store 搜索中文簡體版“薯條電動滑軌”或英文版“new chips slider english”

* 需要IOS7.0或更高版本, 與iphone、ipad和ipod touch兼容

安卓Android用戶

前往 Google play 搜索英文版“new chips slider english”

或前往 百度手机助手 搜索中文簡體版“薯条电动滑轨”

* 需要Android4.3或更高版本, 與Android手机兼容



掃碼下載
薯條電動滑軌
安卓APP

滑軌供電方式

1.移動電源供電

通過官方的移動電源轉接線, 可以使用市面上大部分移動電源給CHIPS電動滑軌供電。1000毫安移動電源在視頻模式下可連續工作8-10小時; 縮時攝影模式下可持續使用約15-18小時, 以此類推。

2.官方鋰電池供電

CHIPS電動滑軌官方有選配的內置電池 (即索尼NP-FW50電池)

工作模式

CHIPS電動滑軌通電后, 開啟手機藍牙并打開“new chips slider english”APP, 即可連接CHIPS電動滑軌。

* 由於NEW CHIPS slider與滑軌連接不需要藍牙配對密碼, 如果在手機旁同時有兩台CHIPS滑軌通電, “new chips slider english”app會隨機選擇一台滑軌進行配對連接。

1.起始位置設置 Starting Position

此模式主要用於設置滑軌起點與終點, 長按“方向左”按鈕將滑塊移動到你想要的A點的位置, 點擊“確認”, 隨後長按“方向右”按鈕將滑軌移動到你想要的B點的位置, 點擊“確認”, 即可完成起始點設置。

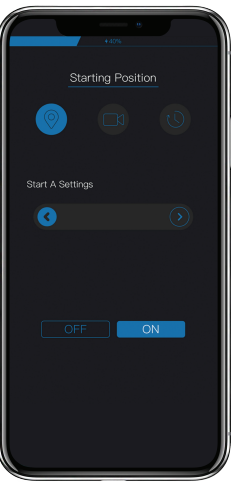

起始位置設置

2.視頻拍攝模式 Video Shot

此模式主要用於視頻拍攝, 常見功能有:

- 緩啟動: 滑塊在起步階段會比較緩慢, 避免快速啟動導致拍攝畫面抖動
- 速度調節speed: 調節速度快慢
- 運動方向調節: 調節運動方向
- 暫停: 暫停運作
- 自動往返Auto round: 開啟后, 滑軌滑塊滑動到終點后會自動返回, 直到沒電才會停止若關閉, 滑軌滑到終點會停止。

* 視頻拍攝模式下, 滑軌運動時會有電機的工作噪聲, 距離CHIPS滑軌較近的話, 麥克風會錄進電機運作的聲音。

* 同等速率下, 滑軌擺放的傾斜度越大, 滑軌移動的速度就會越慢。

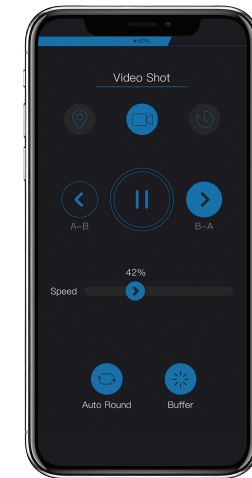

視頻拍攝模式

3.縮時攝影模式 Time Lapse

此模式主要用於縮時攝影拍攝, 常見功能有:

- 時間間隔Delay: 每拍一張照片的時間間隔單位為秒/s, 調節區間為1s-999s
- 拍攝張數Photos: 本次縮時攝影需要拍攝照片的張數調節區間為1-∞, 若設定為100, 則相機完成拍攝100張照片后會停止拍攝。
- 運動方向調節: 調節運動方向

* 視頻模式和縮時攝影模式都有“自動往返”功能, 不過自動往返功能的開關只能在視頻模式界面開啟和關閉

4.脫機功能

當你在“new chips slider english”APP中設置好運動參數后你可以退出“new chips slider english”, 甚至是關閉手機, 這都不影響薯條電動滑軌的正常工作。不過, 如果在視頻拍攝模式下切換到縮時攝影拍攝模式, 這會令滑軌暫停工作, 同理在縮時攝影模式下切換到視頻拍攝模式也會導致脫機功能失效。

規格參數

型號	洋葱工廠薯條電動滑軌
尺寸(mm)	400*45*45, 500*45*45, 700*45*45 1000*45*45, 1200*45*45, 1500*45*45
淨重	1328g, 1345g, 1702g 2447g, 2799.3g, 3262.7g
螺口標準	上3/8, 下1/4與3/8兼容
材質	鋁合金
水平承重	10kg
傾斜承重	1.6kg
兼容性	安卓4.3或更高版本 / IOS7.0或更高版本
續航時間	標準NP-FW50電池視頻拍攝≈5小時 縮時攝影≈20小時

保修信息 WARRANTY INFORMATION

用戶信息 USER INFORMATION

姓名 NAME _____ 電話 TEL _____

郵箱 EMAIL _____ 地址 ADD _____

產品信息 PRODUCTS INFORMATION

產品名稱 PRODUCT NAME _____

產品型號 PRODUCT MODEL _____

出產日期 DATE OF PRODUCTION _____

保修期限 WARRANTY PERIOD _____

保修條例

1本產品自購買日期起保修1年;

1.Warranty period is 1 year, which begins from the purchasing date.

2.擅自拆卸產品以及人為造成的損壞擠不保修。

2.No warranty for disassembly without authorization or damage caused by human.





PRODUCT OVERVIEW

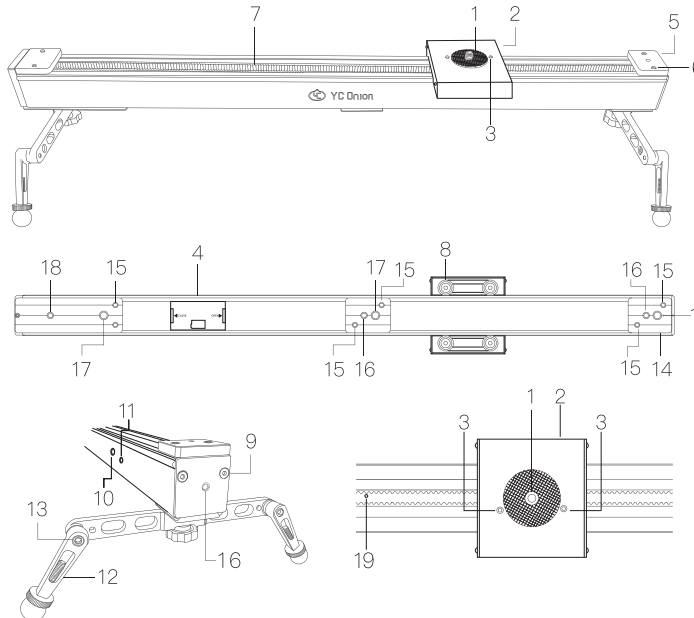

- 1 – Screw On Top: 3/8 screw
- 2 – Sliding Block On Top
- 3 – Adjustable Hexagonal Screw
- 4 – Battery Compartment
- 5 – The Top Side Cover Plate
- 6 – Hexagonal Screw On The Top Cover Plate
- 7 – Strap
- 8 – Pulley
- 9 – Hexagonal Screw On The Side Cover Plate
- 10 – Power Hole
- 11 – Cable Release Hole
- 12 – Support Rod
- 13 – Hexagonal Screws For Support Rod
- 14 – Underneath Quick Release Plate
- 15 – Hexagonal Screws For Underneath Quick Release Plate
- 16 – 1/4 Screw Hole
- 17 – 3/8 Screw Hole
- 18 – Safe Screw Hole Of Motor (Don't use overlong screw to install this hole, otherwise it will damage motor possibly.)
- 19 – Power Led

PRODUCT LIST AND FUNCTION

Standard Equipments

Storage Bag, CHIPS Electric Slider Main Part, Support Rods x 2, mobile power transfer line, Hexagon Wrench

Optional Equipments

Cable Release, Battery (NP-FW5), Battery Charger, Crab Claw Support Rod x 2, Tripod Global, Head, Hydraulic Head

DOWNLOAD APP

Apple IOS

Search "new chips slider english" in [APP Store](#)

* Need IOS7.0 or higher version, compatible with iPhone, iPad and iPod touch.

Android

Search "new chips slider english" in [Google play](#)

* Need Android 4.3 or higher version, compatible with Android mobile phone.



Scan QR code
Download CHIPS Android APP

POWER SUPPLY MODE FOR SLIDER

1. Mobile Power Supply

With the official mobile power extension cable, you can use lots of mobile power to supply power to CHIPS electric slider.
1000mAh mobile power can work for 8–10 hours in the video shooting mode, can work for 15–18 hours for time-lapse shooting mode, and so on.

2. Official Lithium Battery Supply

There is official optional lithium battery for CHIPS electric slider (Sony NP-FW50 battery)

WORKING MODE

Turn on CHIPS electric slider, initiate Bluetooth function of phone and click on "new chips slider english" APP. And mobile phone can connect to CHIPS slider.

* Because of no code match when we connect mobile phone and CHIPS slider, if there are two CHIPS slider working at the same time, "new chips slider english" app will match a slider at random.

1. Starting Position Mode

This mode is used for setting up the starting point and end point of the slider. Long press on the button "Left" to move the slider to the position you want (Position A), and click "Confirm". Then long press on the button "Right" to move the slider to the position you want (Position B), and click "Confirm". The setting is finished.

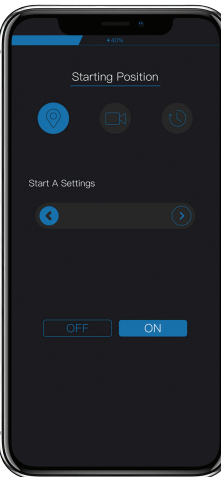

Starting Position Mode

1. Video Shot Mode

This mode is used for video shooting, common functions are:

- Soft-start function: To avoid jerky video which cause by fast start-up, the slider will begin with a soft start.
- Speed control: adjust speed fast or slowly
- Moving direction control: adjust moving direction
- Pause: Pause to work
- Auto round: Open this function, sliding block will return automatically when it arrived the end of slider.

Close this function, sliding block will stop when is arrived the end of slider.

* In the video shot mode, there will be working noise of motor when sliding track is moving. If microphone is near CHIPS slider, it will record the voice of motor working.

* At the same speed, the larger angle of inclination of slider is, the slower speed slider moves.

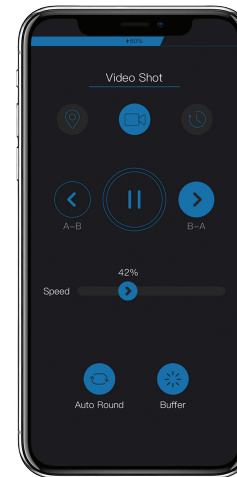

Video Shot Mode

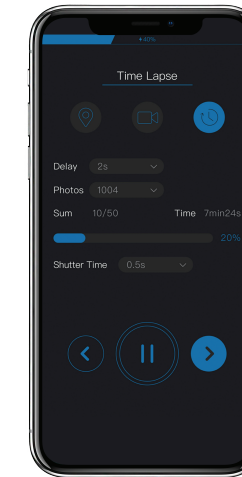

Time Lapse Mode

2. Time Lapse Mode

This mode is used for time-lapse shooting, common functions are:

- Delay: time interval of shooting each photo
Unit is second(S), adjustment range: 1s–999s.
- Photos: how many photos do you want in this time-lapse shooting.
- Adjustment range: 1–∞. If you adjustment is 100, camera will shoot 100 photos before it stop shooting.
- Moving direction control: adjust moving direction

* Both video shot mode and time lapse mode have the function of "automatic round". But we can only open or close this function in video shooting mode interface.

3. Offline Function

After setting moving parameters in "new chips slider english" APP, you can exit "new chips slider english", even turn off your phone. It doesn't affect CHIPS slider work. However, if you switch video shot mode to time lapse mode, slider will stop working. Also, if you switch time lapse mode to video shot mode, offline function will be not work.

SPECIFICATIONS

MODEL	YC Onion CHIPS Motorized Camera Slider
SIZE(mm)	400*45*45, 500*45*45, 700*45*45, 1000*45*45, 1200*45*45, 1500*45*45
NET WEIGHT	1328g, 1345g, 1702g, 2447g, 2799.3g, 3262.7g
MOUNTING OPTION	3/8 mounting screw on top, 1/4 or 3/8 mounting port on bottom.
MATERIAL	Aluminium alloy
HORIZONTAL LOAD BEARING	10 kg or less
INCLINED LOAD BEARING	1.6kg or less
COMPATIBILITY	Android 4.3 or higher, IOS7.0 or higher
DURATION OF FLIGHT	Standard NP-FW50 battery for video shooting≈5 hours for time-lapse shooting≈20 hours

警告和免責聲明 DISCLAIMER

1.對於本產品，本公司不承擔終端客戶對本產品所有調試和使用當中的風險和責任(包括直接、間接或者第三方的損失)；

1.The company assumes no liability for any risks related to or resulting from the debug and use of this product (including the direct, indirect or third-party losses).

2.我公司對於任何從非正常渠道獲取的產品，將不予任何服務；

2.For any unknown sources of acquiring this product, we will not be at any services.

3.由於產品固件程序的升級和更改，有可能造成本說明書中描述的功能有變動，省勁固件前請仔細閱讀升級說明；

3.The updating and changes of product firmware and program may cause changes in function descriptions in this user manual, please read the instructions carefully before upgrading the firmware and use the corresponding user manual.

4.可能存在因產品硬件升級改造后與本說明書不符的描述，請以官網發佈的最新產品信息為準；

4.There may be a description that does not conform to this specification after firmware upgrade of the product. Please be subject to the latest product information which is issued in official website.

5.本公司對本產品保留一切解釋權利。

5.The company reserves all rights of interpretation to this product.



官方網站 | www.yconionca.com

[Instagram](#) | [yc.onion](#)

[YouTube](#) | YC Onion

[Facebook](#) | YC.Onion

[WeChat](#) | 洋蔥工廠YCOnion